

PWC-1300 BILL OF MATERIALS

511-10000-00	LIFT, PIVOT PWC-1300		
<u>NO.</u>	<u>PART NUMBER</u>	<u>DESCRIPTION</u>	<u>QTY</u>
1	002-03305-00	BRACE, SCTN'L/P1300 – 22.5"	2
2	002-03310-00	CLAMP, FRAME BEAM (FEMALE)	4
3	006-15210-00	CAP, VINYL 2" SQ. LIFT CORNER	3
4	111-00091-00	ASS'Y, 2" PULLEY BLOCK W/ 3 LINKS	1
5	111-00263-00	WELD'T, PIVOT ARM PWC1300	2
6	111-00264-00	WELD'T, FRAME BEAM "A" PWC1300	1
7	111-00265-00	WELD'T, FRAME BEAM "B" PWC1300	1
8	111-00289-00	ASS'Y, PWC-1300 WINCH	1
9	111-00551-00	ASS'Y, ADJUSTABLE LEG – 30"	4
10	111-00552-00	ASS'Y, SIDE FRAME "A" PWC1300	1
11	111-00553-00	ASS'Y, SIDE FRAME "B" PWC1300	1
12	111-01262-00	ASS'Y, CRADLE PWC1300	1
13	511-04206-00	FASTENERS, P1200/PWC1300 LIFT	1

PWC-1300 Frame Exploded View A

LIFT P/N 511-10000-00

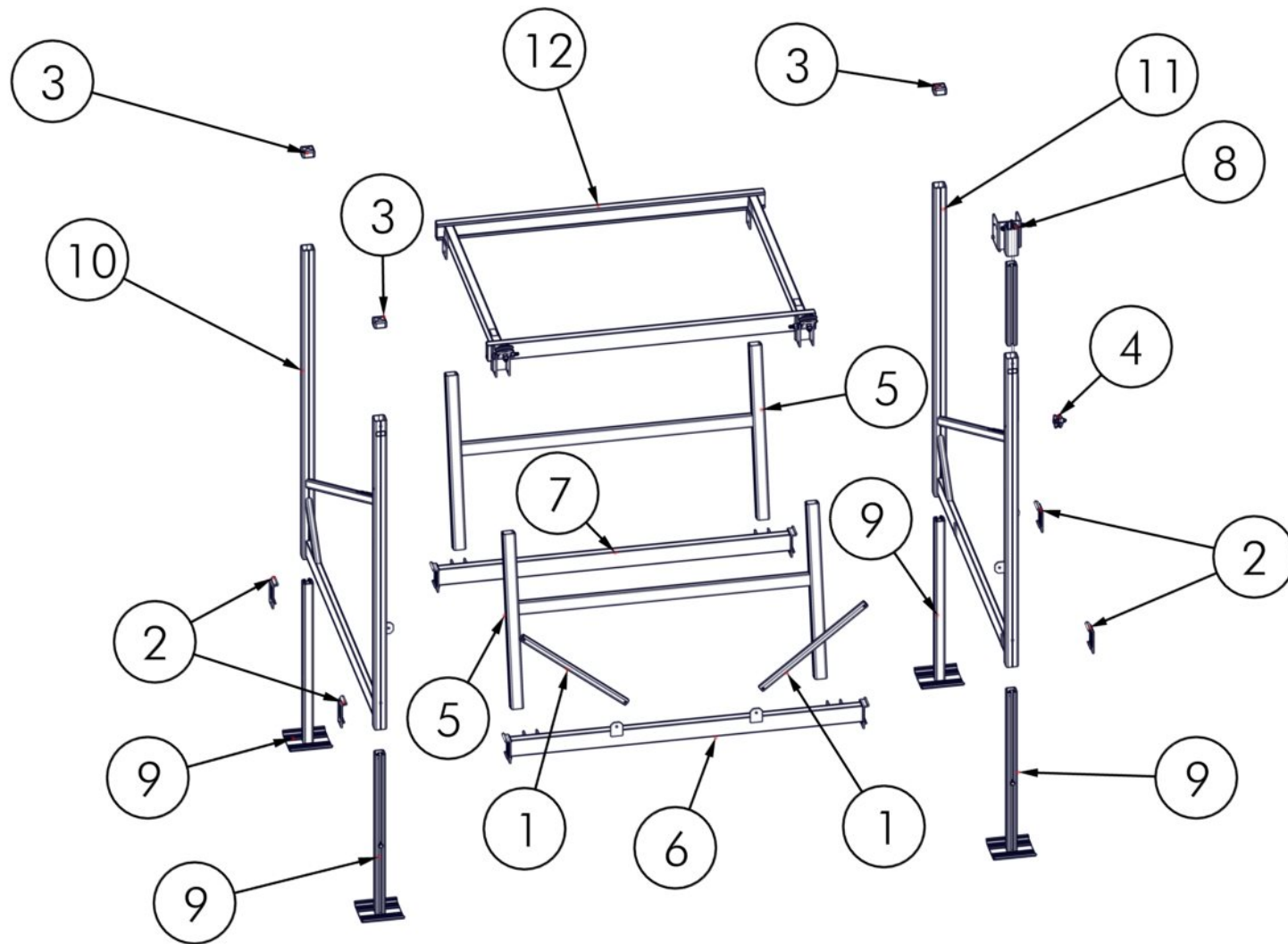

PWC-1300 BILL OF MATERIALS

<u>NO.</u>	<u>PART NUMBER</u>	<u>DESCRIPTION</u>	<u>QTY</u>
13	511-04206-00	FASTENERS, P1200/PWC-1300	1
13A	001-70010-00	HHCS, 1/4-20 X 1-3/4" 18-8 SS	2
13B	001-70103-00	HHCS, 3/8-16 X 3/4" 18-8 SS	1
13C	001-70110-00	HHCS, 3/8-16 X 1-3/4" 18-8 SS	4
13D	001-70111-00	HHCS, 3/8-16 X 2" 18-8 SS	4
13E	001-70115-00	HHCS, 3/8-16 X 3" 18-8 SS	2
13F	001-70219-00	HHCS, 1/2-13 X 4" 18-8 SS	8
13G	001-71017-00	FLAT WASHER, 3/8" SAE SS 18-8	3
13H	001-71021-00	FLAT WASHER, 1/2" 18-8 SS	16
13I	001-75001-00	NUT, NYLOCK 1/4-20 ALUM.	2
13J	001-76071-00	NUT, NYLOCK 3/8-16 ALUM.	10
13K	001-76072-00	NUT, NYLOCK 1/2-13 ALUM.	8
13L	001-76349-00	NUT, 3/8-16 ALUM.	1

PWC-1300 Frame Exploded View B

LIFT P/N 511-10000-00

NOTE:
ADDITIONAL VIEWS ON
FOLLOWING PAGES

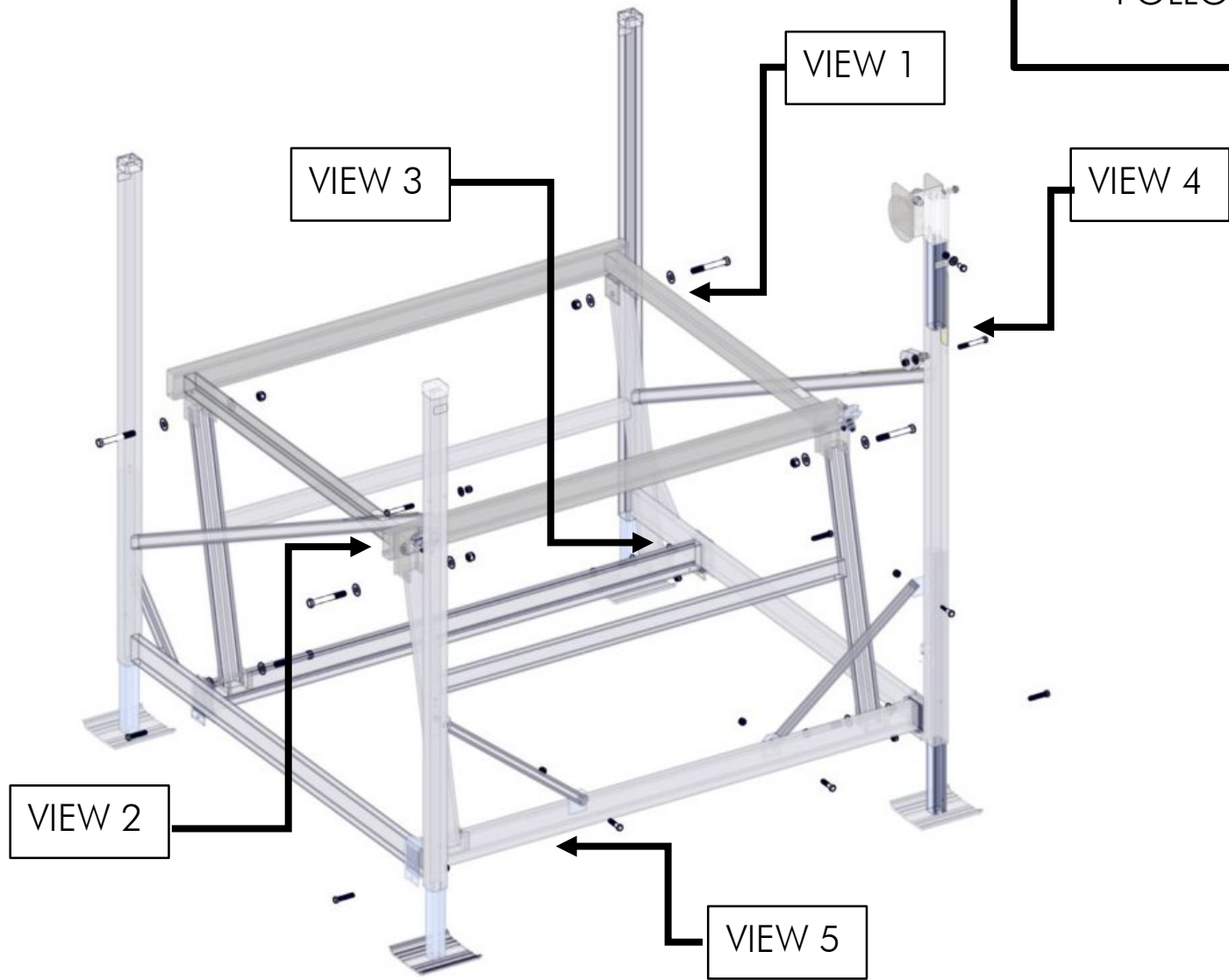

PWC-1300 Frame Exploded Views 1 & 2

LIFT P/N 511-10000-00

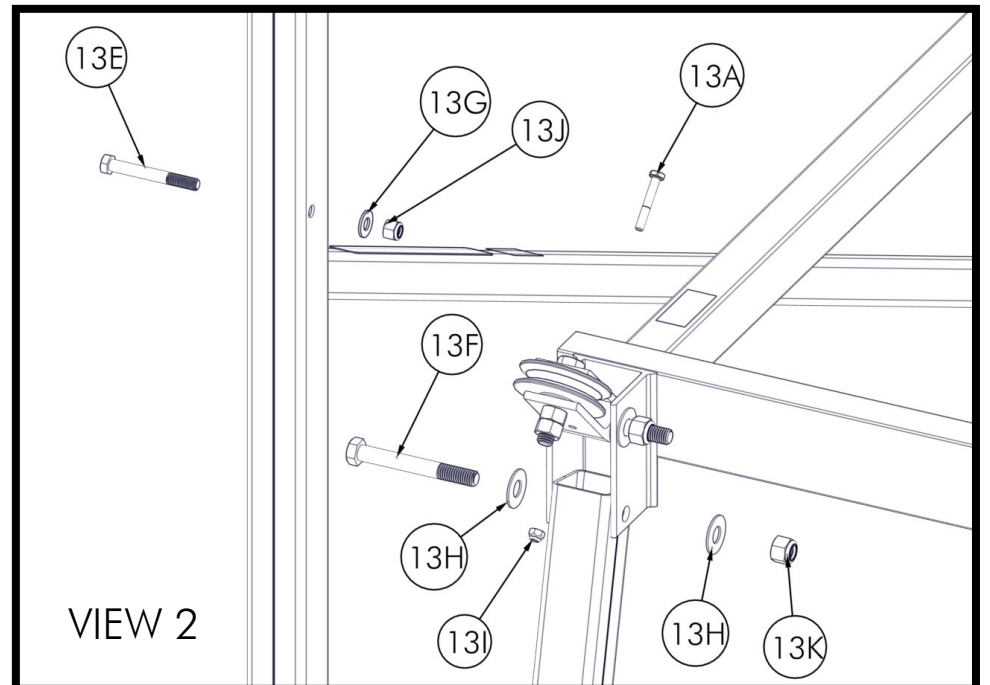
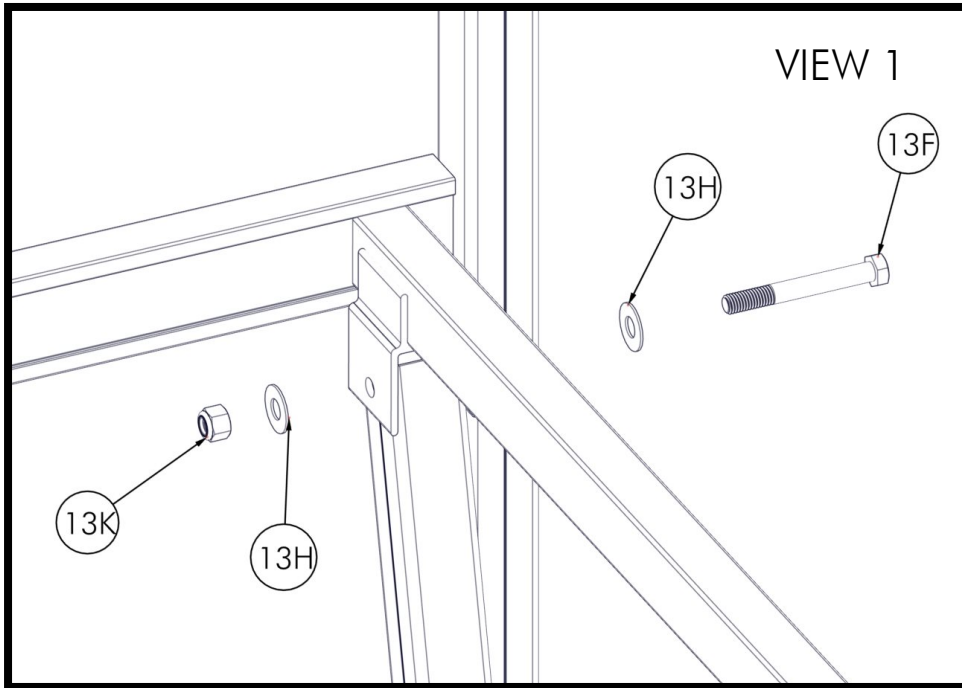

PWC-1300 Frame Exploded Views 3-5

LIFT P/N 511-10000-00

